

Single-Acting Cylinder MS series (return-by-spring type)

Description of the type

MS 05 - 50

Maximum output
05 : 50 kN

Attached coupler
No mark : ROC-13R
S : S-1R
NC : W/O coupler

MS series Stroke (mm)

●The piston and the inner side of the cylinder tube are coated.

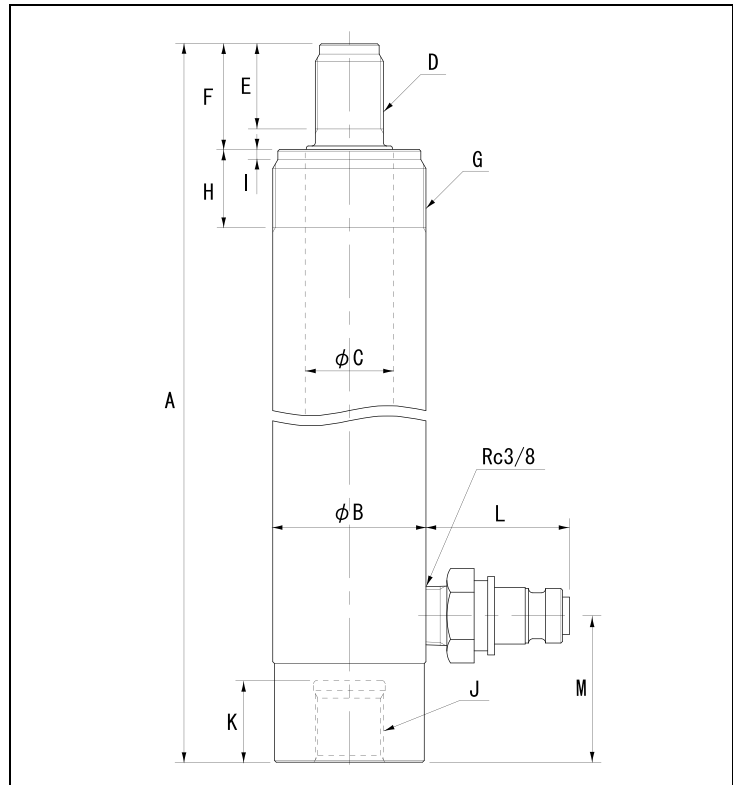

■ Specification

		50kN				
Type		MS05-50	MS05-75	MS05-100	MS05-125	MS05-150
Maximum operating pressure	MPa	70				
Maximum output	kN	50				
Pressure area	cm ²	7.16				
Stroke	mm	50	75	100	125	150
Minimum overall length	A	154	211	236	261	286
Inner diameter of the cylinder	φ	30.2				
Outside diameter of the cylinder	φB	46	45			
Piston diameter	φC	26				
Piston screw diameter	D	M20 × 1.5				
Piston screw length	E	25				
Piston ejection length	F	31				
Collar screw diameter	G	M45 × 1.5				
Collar screw length	H	23				
None thread length	I	3				
Base screw diameter	J	-	M20 × 1.5			
Base screw depth	K	-	24			
Coupler ejection length	L	≒48	≒42			
Coupler position	M	20	43			
Coupler connection diameter	-	Rc3/8				
Attached coupler	-	ROC-13R				
Necessary oil level	cm ³	36	54	72	90	108
Approximate weight	kg	1.5	2.0	2.3	2.5	2.7

■ Available attachments

		MS05-50	MS05-75	MS05-100	MS05-125	MS05-150
Piston	Cap	R-5PM				
	Tilt saddle	-				
	Piston base	RB-5M				
	Clevis	CLF-5-1 (2)				
Flange	5FM					
Base	Cylinder base	-	CB-5M			
	Clevis	-	CLM-5-1 (2)			