

Double-Acting Cylinder D series

Description of the type (in case of D3.5)

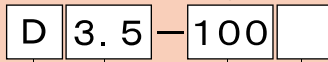

Maximum output 3.5 : 350 kN Attached coupler No mark : S-1R T : ROC-13R NC : W/O coupler

D series Stroke (mm)

●The piston is coated.

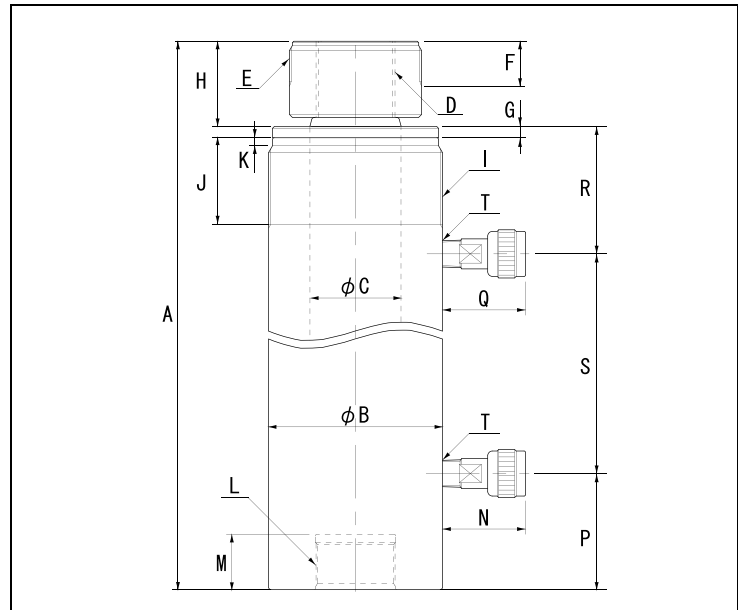

Specification

		350kN			500kN				
Type		D3.5-100	D3.5-150	D3.5-300	D5-50	D5-100	D5-150	D5-300	D5-500
Maximum operating pressure	MPa	70			70				
Push side	Maximum output	350			500				
	Effective area	50.26			71.63				
Pull side	Maximum output	178			279				
	Effective area	25.63			40.04				
Stroke	mm	100	150	300	50	100	150	300	500
Minimum overall length	A	346	396	545	288	338	387	589	789
Inner diameter of the cylinder	ϕ	80.0			95.5				
Outside diameter of the cylinder	ϕ B	110			128		127		
Piston diameter	ϕ C	56			63.42				
Piston screw diameter	D	M50 × 2			M55 × 3				
Cap screw diameter	E	-			M92 × 2.5				
Cap screw length	F	-			28				
No thread length	G	7			12				
Piston ejection length	H	53			60				
Collar thread diameter	I	M110 × 2.5			M127 × 2.5				
Collar thread length	J	55			55				
None thread length	K	5			3				
Base screw diameter	L	M50 × 2			-		M55 × 3		
Base screw depth	M	35			-		55		
Push side	Coupler ejection length	≒53			≒56				
	Coupler position	73.5			25		84		
Pull side	Coupler ejection length	≒53			≒56				
	Coupler position	80.5			91		89		
Distance between ports	S	139	189	338	112	162	211	356	556
Coupler connection diameter	T	Rc3/8			Rc1/2				
Attached coupler	-	S-1R			S-24R				
Necessary oil level	cm ³	503	754	1508	359	717	1075	2149	3582
Approximate weight	kg	20.0	23.5	32.0	24.5	28.0	31.5	46.0	60.5

Available attachments

		D3.5-100	D3.5-150	D3.5-300	D5-50	D5-100	D5-150	D5-300	D5-500
Piston	Cap	R-35P			R-50P				
	Piston base	RB-35			RB-50				
	Clevis	CLF-35-1 (2)			CLF-50-1 (2)				
Flange	35F			50F					
Cylinder hanging hook	-			TH-127 (Handle type)					
Base	Cylinder base	CB-35			-		CB-50		
	Clevis	CLM-35-1 (2)			-		CLM-50-1 (2)		